



## The sensors of loading chutes clogging (gumming) checking, with magnetically operated sealed switch - Д3Г-...

**Series sensors Д3Г-...** are designed for conveyor loading chutes clogging checking when transporting coal, mining rocks and other solid loose materials. Steel housing provides heightened impact and wear resistance of sensor that allows to use it in the tough operating conditions.

The product is based on the sensor of limit angle of inclination ( the FIPS's (Federal Institute of Industrial Property) decision on the grant of a patent of 04.08.2011, application № **2011126961** of 30.06.2011) which does not contain mercury as distinct from their foreign counterparts. Using this principle minimizes the mechanical components thereby providing the high reliability and durability of the product. Built-in hydro stabilizer damps a vibration thereby greatly reducing the possibility of false activations.

### Specifications:

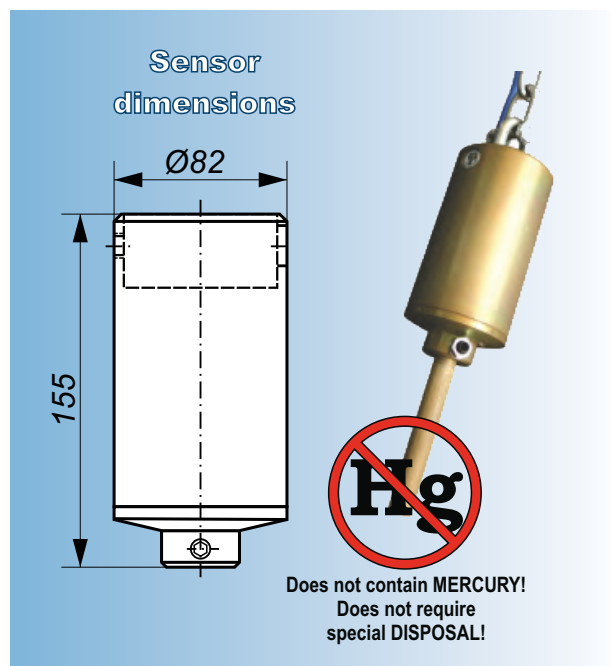

Angle of actuation, degree	30
Switching voltage, V	0,05 - 200DC/0,05 - 250AC
Switching current, I <sub>max</sub> mA	1000
Power handling, W	30
Resistance, Ohm, not more than	0,15
Operating temperature range, °C	
• high- temperature - <b>BT</b>	t= -15°...+105°C
• typical execution	t= -25°...+75°C
• low-temperature - <b>HT</b>	t= -45°...+65°C
• low-temperature - <b>2HT</b>	t= -65°...+50°C
Protection degree	IP68
Подключение с помощью кабеля, L=2м	3x0,34 mm <sup>2</sup>
When ordering other lengths, indicate the number of meters in the end of the denomination ( see example of notation)	
Case material	steel 45
Dimensions, mm	Ø82x155
Weight of sensor without extension , kg	2,1

### Wiring diagramms:

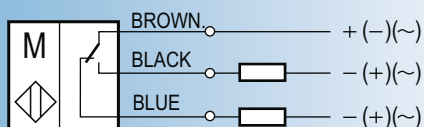

### Advantages of the Д3Г-... series sensors:

- sensor circuit requires no power;
- the ability to connect a large number of sensors in one cable sequentially one after another;
- high protection degree – IP67;
- the possibility of manufacturing of materials resistant to corrosive media.

### Example of sensors notation in the documentation and orders:

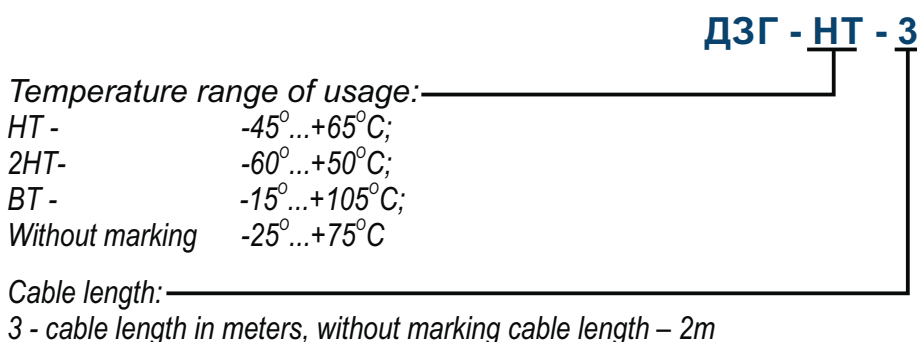



# CONVEYOR AUTOMATION

*Д3Г-... series sensors are available in several versions that differ from each other in connection diagrams, supply voltage, operating temperature ranges and cable length.*

Д3Г sensor construction allows to set various types of extensions to it (see add. equipment), that makes it versatile in detecting loose materials of various fractions, liquids and considerably extends range of use.

## Optional equipment for the Д3Г-...series sensors

### EXTENSIONS

Type	Size	№ for order
Rod	Ø16x120	№11
Rod	Ø16x240	№12
Paddle small flat	16x100x120 16x100x240	№21 №22
Paddle large flat	16x200x120 16x200x240	№31 №32
Paddle small cruciform	100x100x120 100x100x240	№41 №42

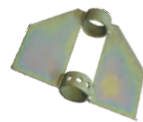

Type	Size	№ for order
Paddle large flat	200x200x120 200x200x240	№51 №52
Nozzle flat	44x160x200	№61
Nozzle cruciform	160x200x200	№62
Float	Ø120	№71
Float	Ø200	№72

### BRACKETS

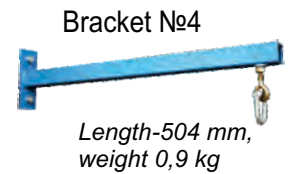

## Options of Д3Г-...series sensors use

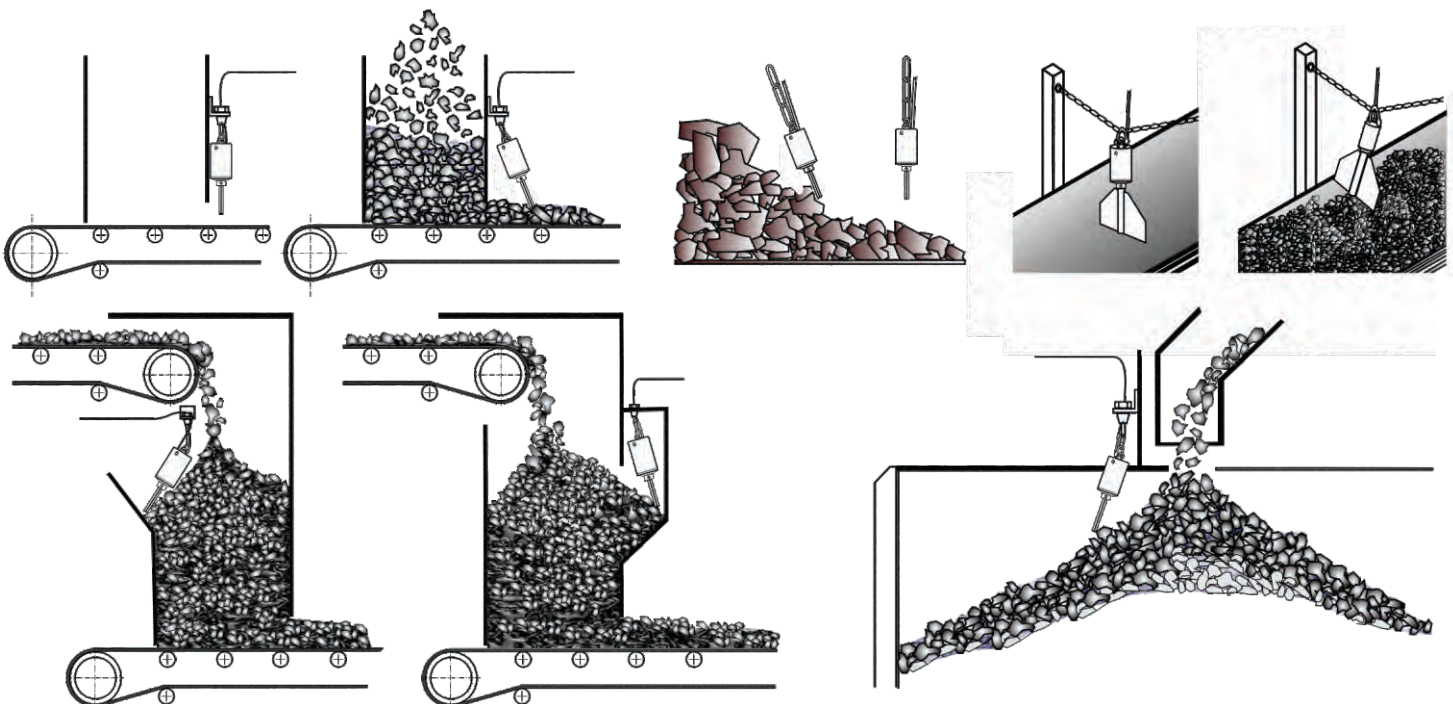

«Pilot Production «Technologies of Control» Co. Ltd

630117, Novosibirsk, Arbusova street, 2a  
Phone: (383) 332-49-32, 299-32-02, 335-64-09  
sale@op-teko.ru www.op-teko.ru